

AVAILABLE PROPERTY



9503

Winona Street
Schiller Park, IL



HIGHLIGHTS

- 37,500 Sq Ft Total Building
- +/- 10,000 Sq Ft office space (about 6,000 can be demolished)
- 20' Clear Ceiling Height
- 1 Drive In Door (12' x 14')
- 4 interior Docks
- 1 Rail Door (not active)
- 800 amps power
- +/- 40 Car parking
- Fully Sprinklered
- Brick Construction

Matt Mulvihill

847.655.8440

matt.mulvihill@grubb-ellis.com

Ryan Kehoe

847.655.8486

ryan.kehoe@grubb-ellis.com



GRUBB & ELLIS.
From Insight to Results

9503

Winona Street
Schiller Park, IL



AVAILABLE

LOCATION MAP

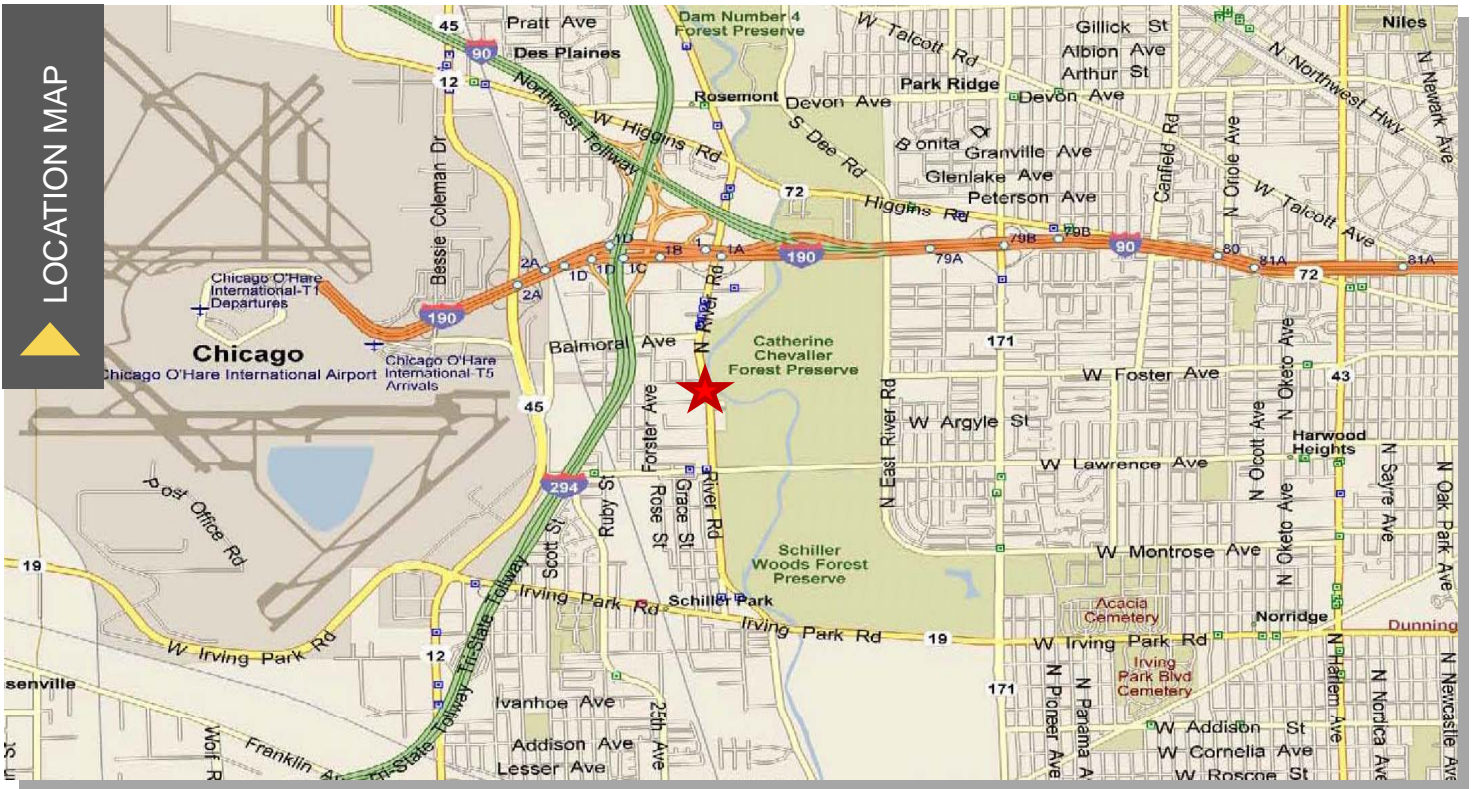

FLOOR PLAN

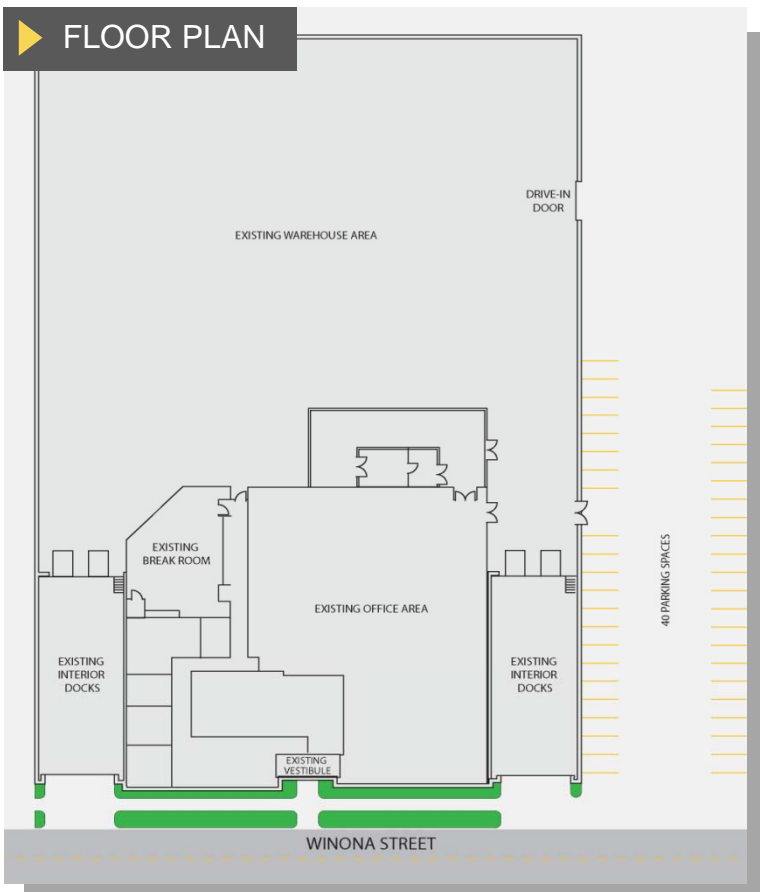

Matt Mulvihill

847.655.8440

matt.mulvihill@grubb-ellis.com

Ryan Kehoe

847.655.8486

ryan.kehoe@grubb-ellis.com



GRUBB & ELLIS.
From Insight to Results